



Parts and Accessories Installation Instructions

Installation Kit Mini Additional Instruments MINI (R 50/R 53)

The installation time is approx. 1.0 hours, but this may vary depending on the condition of the car and the equipment in it.

Retrofit kit No. 82 94 0 148 956

Important information for the installation of the additional instruments

The additional instruments may only be installed by a specialist workshop that has the required special tools and manuals.

Ensure that the cables/lines are not kinked or damaged as you install them in the car.
Additional cables/lines that you install must be secured with cable ties.

All the figures show LHD cars, proceed in exactly the same way on RHD cars.

Item numbers refer only to the overview drawings and to the texts next to the appropriate figure.

Subject to technical modifications

Special tools required

None

Contents

| Section | Page |
|--|------|
| Important information for the installation of the additional instruments..... | 1 |
| 1. Preparations | 3 |
| 2. Parts list..... | 4 |
| 3. Connection diagram | 5 |
| 4. Installation and cabling diagram | 6 |
| 5. To install the oil temperature sensor and connection cable..... | 7 |
| 6. To install the installation frame and connect the additional instruments..... | 9 |
| 7. Circuit diagram..... | 10 |

1. Preparations

| | TIS instruction No. |
|---|---------------------|
| Remove the battery and battery box | 1200 |
| Remove the radio | 65 11 030 |
| Remove the centre console | 51 16 200 |
| Disconnect the battery | 61 21 020 |
| R50: Remove the battery and battery box | --- |

2. Parts list

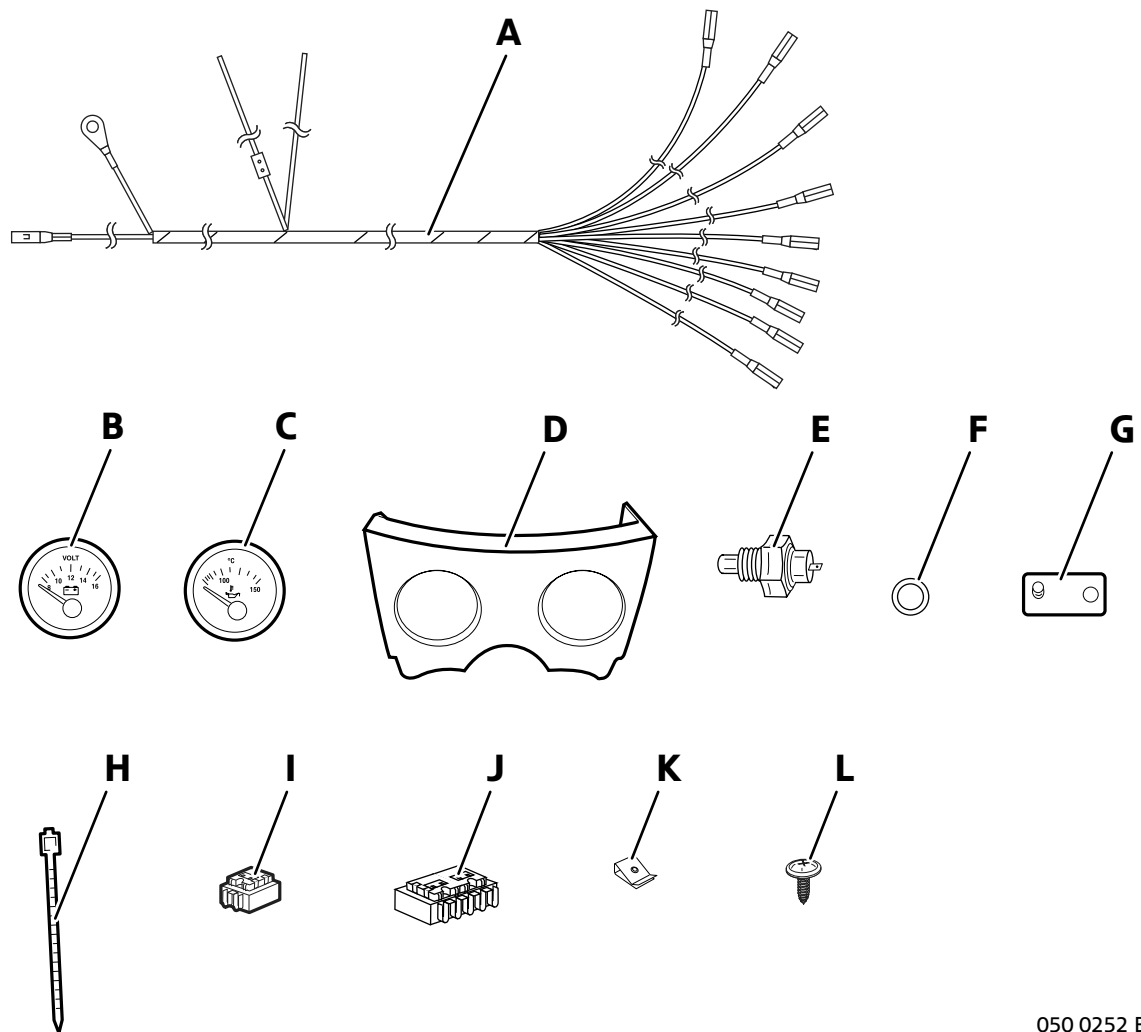

050 0252 B

Legend

- A Connection cable
- B Voltmeter
- C Oil temperature gauge
- D Installation frame
- E Oil temperature sensor
- F Sealing ring A14x20-Cu
- G Earth adapter
- H Cable tie (10x)
- I 2-way insulation-piercing connector
- J 5-way insulation-piercing connector
- K Speed nut 3.5 (2x)
- L Self-tapping screw 3.5 x 16 (2x)

3. Connection overview

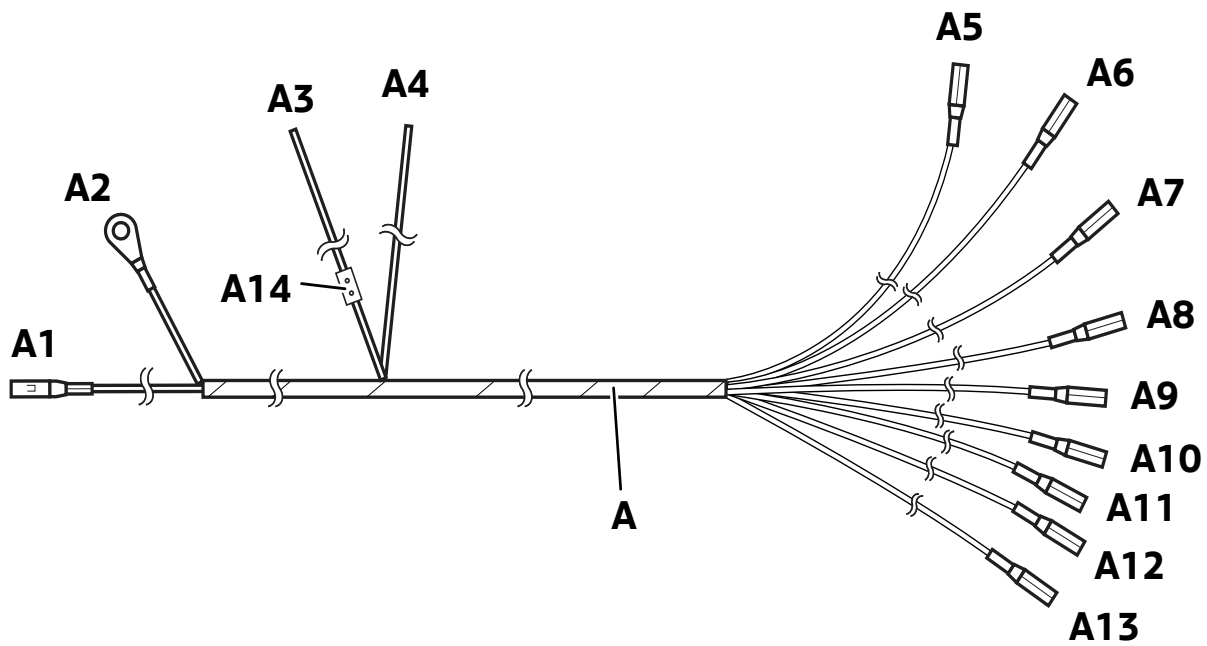

050 0253 B

| Item | Description | Signal | Cable colour/ Cross-section | Connection location in the car | Abbreviation/Slot |
|---------|------------------|-----------|--------------------------------|---|--------------------------------------|
| A | Connection cable | --- | --- | --- | --- |
| A1 | Cable lug | Oil temp. | BL | Oil temperature sensor | --- |
| A2 | Cable eyelet | Earth | BR | Earth post in engine compartment | --- |
| A3 | Open cable end | 15 | RT | To voltage supply cable (RT/GR) for cigarette lighter using 5-way insulation-piercing connector | Pin 2 |
| A4 | Open cable end | 58G | GR/RT | Power supply cable (GR/RT) from radio connection plug | X18126/14 or X2519/13 |
| A5 | Cable lug | Oil temp. | BL | To oil temperature gauge | S device |
| A6-A9 | Cable lug | Earth | BR | To each of the two earth connections of the oil temperature gauge and voltmeter | Negative device Negative lighting |
| A10-A11 | Cable lug | 58G | GR/RT | To lighting from oil temperature gauge and voltmeter | Positive lighting |
| A12-A13 | Cable lug | 15 | RT | To voltage supply from oil temperature gauge and voltmeter | Positive device |
| A14 | Fuse | 15 | --- | --- | --- |

4. Installation and cabling diagram

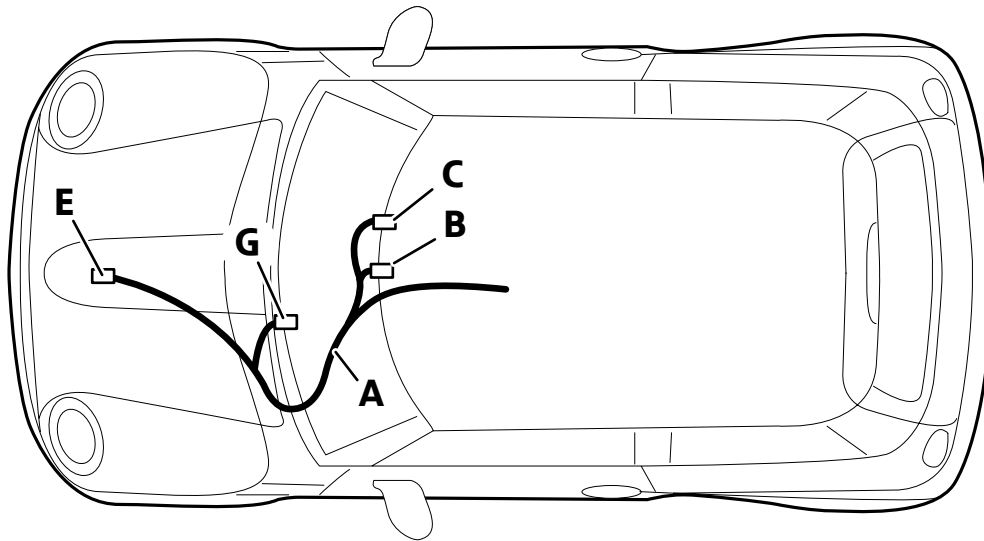

050 0262 B

Legend

- A Connection cable
- B Voltmeter
- C Oil temperature gauge
- E Oil temperature sensor
- G Earth adapter

5. To install the oil temperature sensor and connection cable

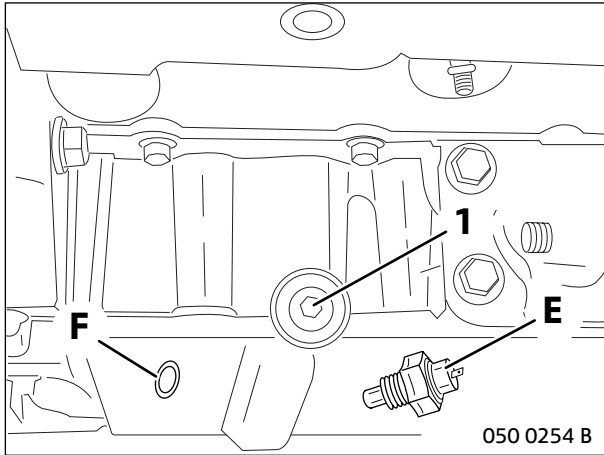

Remove the oil drain plug (1).
Screw in oil temperature sensor E and sealing ring F.
Tightening torque value of oil temperature sensor 25 Nm.



Check the oil level and top up if necessary. ◀

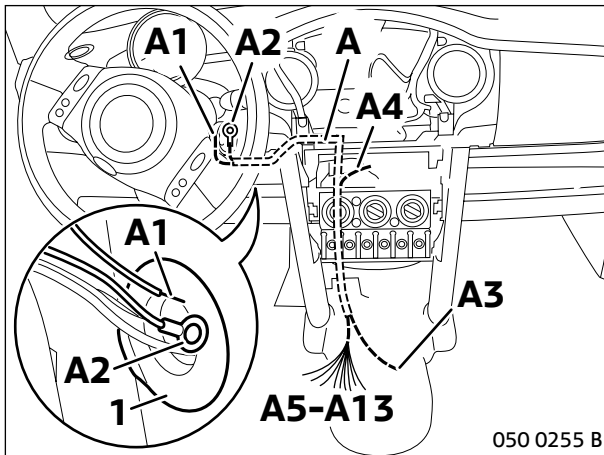

Route connection cable A.
Route A1 and A2 through grommet (1) into the engine compartment. Route A4 to the radio connection plug, A3, A5-A13 to the centre console.

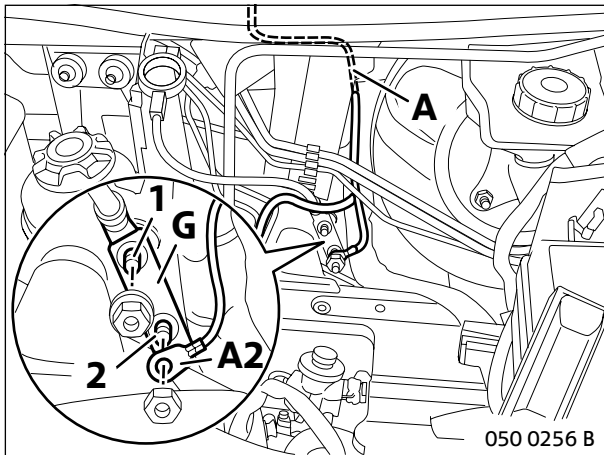

Screw earth adapter G onto earth bolt (1).
Screw A2 onto pin (2).

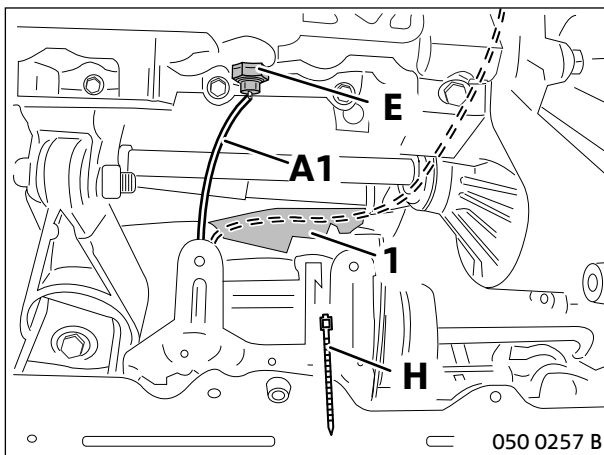

Route A1 along the servo line behind heat shield (1) to oil temperature sensor E and attach with cable ties (H).

5. To install the oil temperature sensor and connection cable

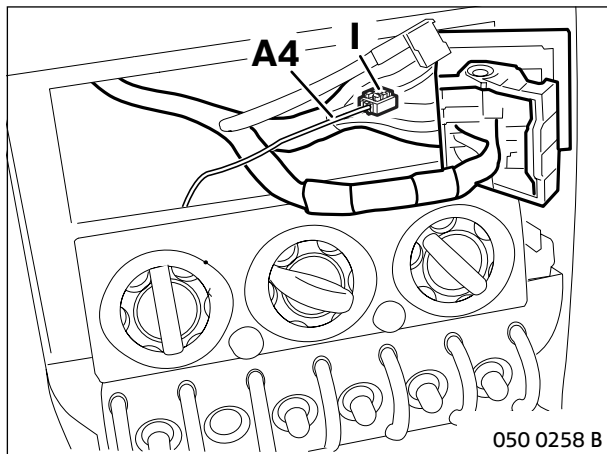

Connect A4 to the GR/RT power supply cable pin 14 (new generation: pin 13) using insulation-piercing connector I.

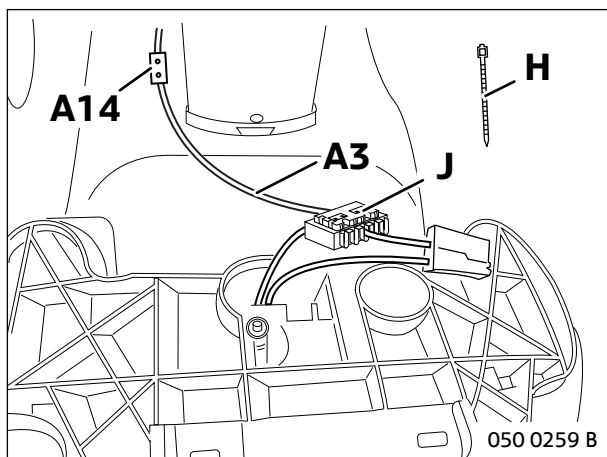

Connect A3 to the RT/GN power supply cable pin 2 of the cigarette lighter using 5-way insulation-piercing connector J.
Attach fuse A14 at a suitable point using cable ties H.

6. To install the installation frame and connect the additional instruments

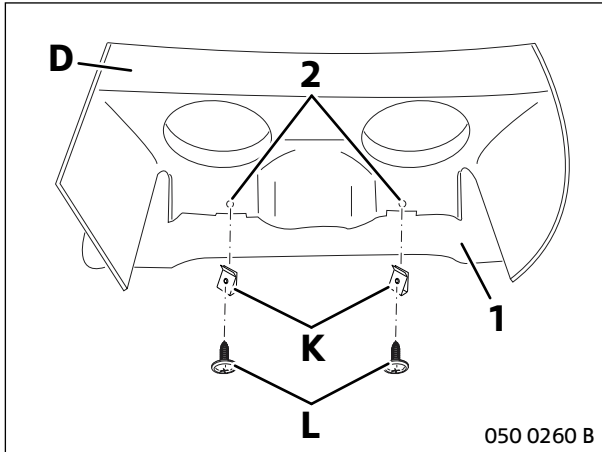

Lay installation frame D on centre console (1) as a drilling template.
Drill a 5 mm hole at each of positions (2). Attach installation frame D using speed nuts K and self-tapping screws L.

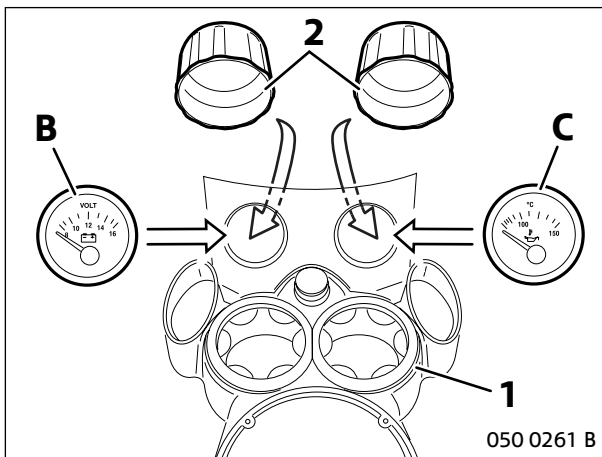

Screw on additional instruments B and C using the fixing rings (2) provided.



Line up the gauges so they are horizontal. ◀

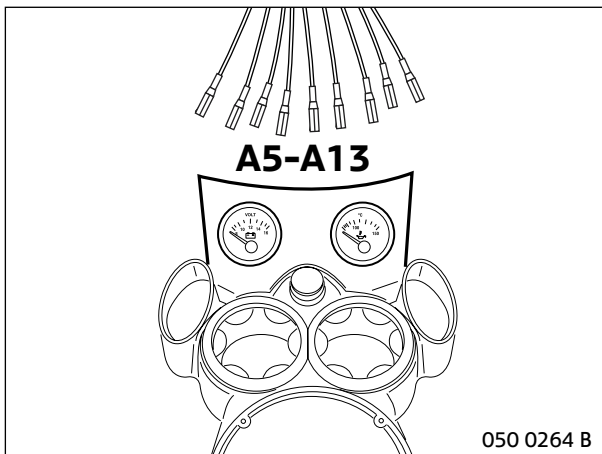

Connect A5-A13 to the additional instruments according to the connection overview.

7. Circuit diagram

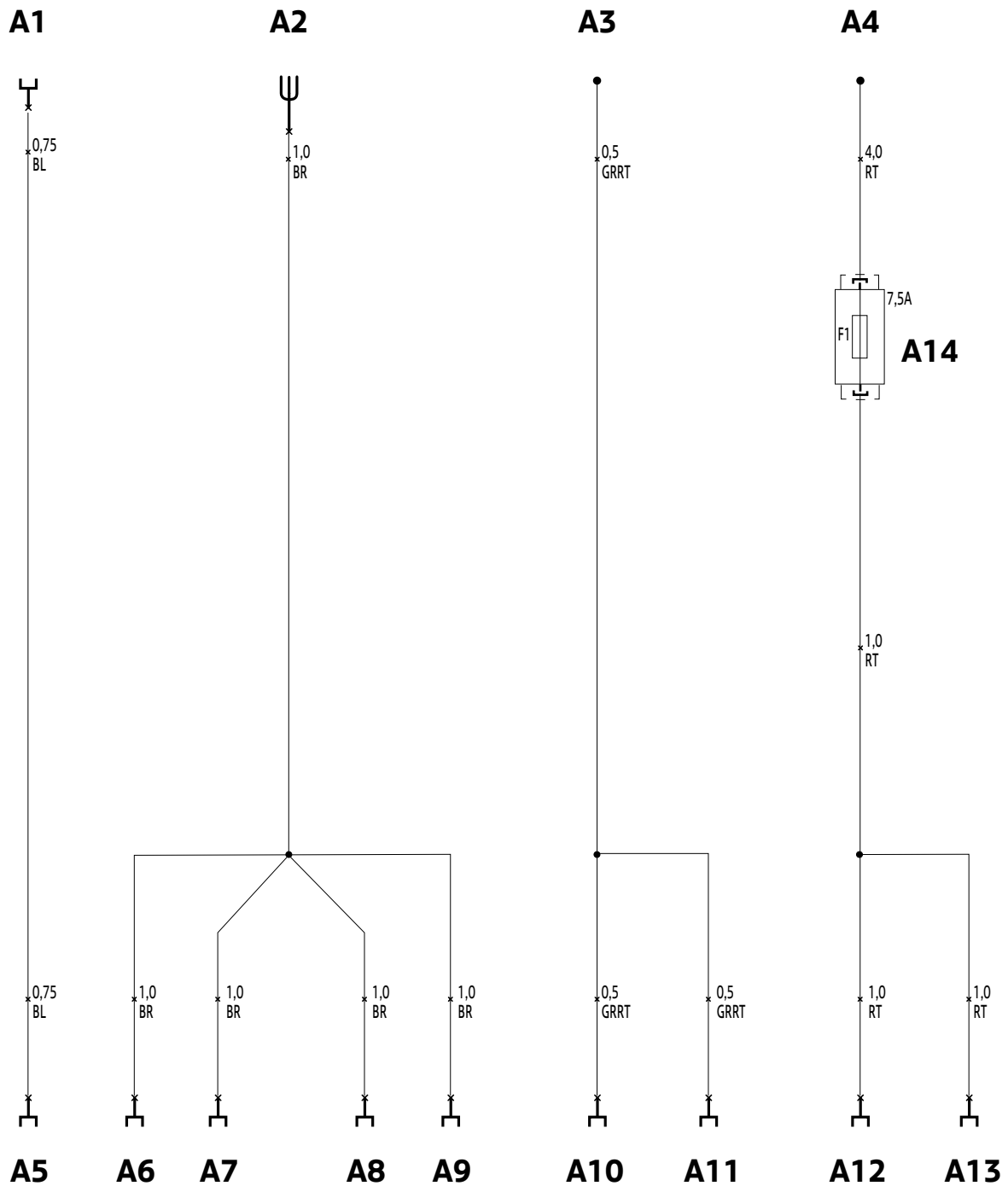

050 0263 B

7. Circuit diagram

Legend

See connection overview

Cable colours

| | |
|----|-------|
| RT | red |
| GN | green |
| BL | blue |
| GR | grey |